

# SHIMANO

## SLX

## SLXDCXT70HG

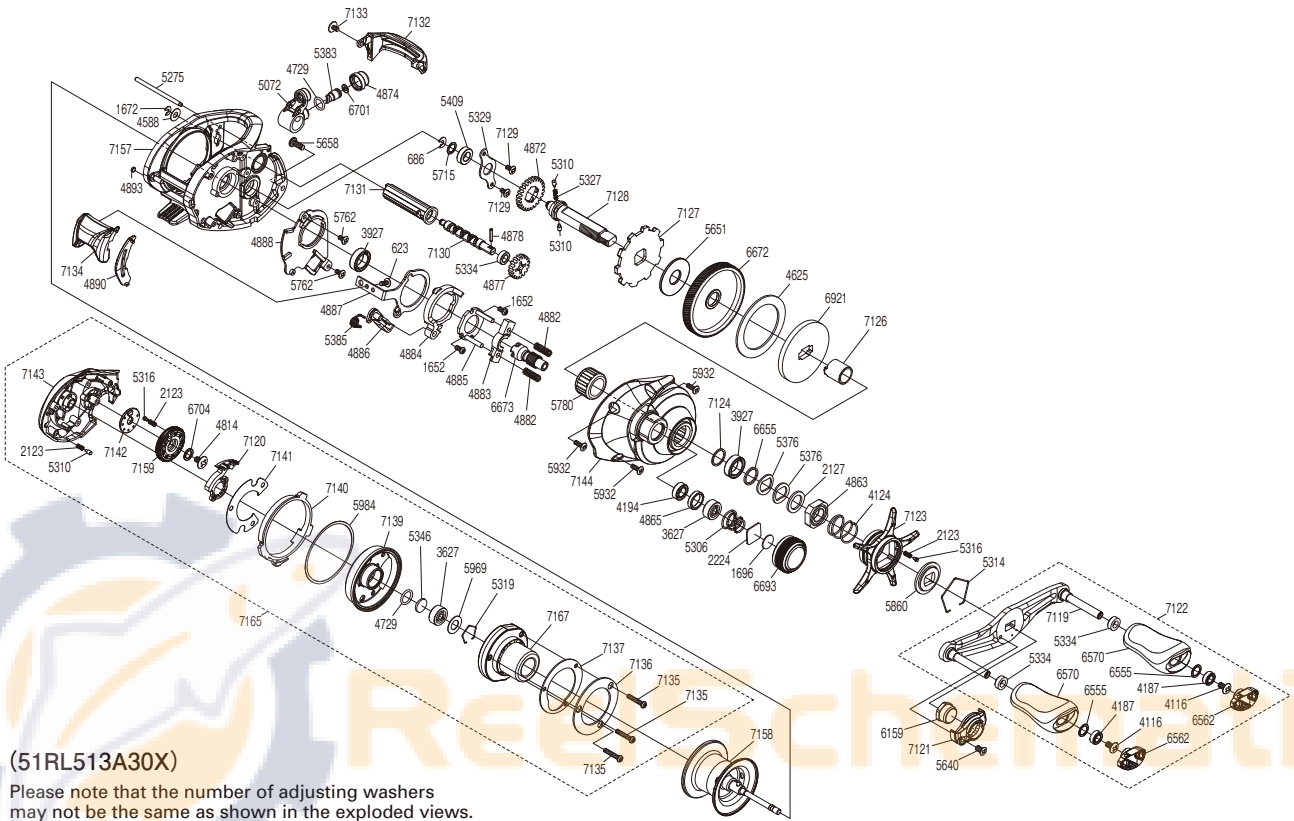

(51RL513A30X)

Please note that the number of adjusting washers may not be the same as shown in the exploded views. (Adjustment will vary with each individual product.)

Part No.	Description	Part No.	Description	Part No.	Description
BNT0623	Screw	BNT5275	Stabilizer Bar	BNT6921	Key Washer
BNT0686	E Lock	BNT5306	Spool Tension Spring	BNT7119	Handle Shank Assembly
BNT1652	Screw	BNT5310	Idle Gear Pin	BNT7120	Magnet Cam Assembly
BNT1672	E Lock	BNT5314	Click Plate Retainer	BNT7121	Handle Nut Plate
BNT1696	Cast Control Spacer B	BNT5316	Click Pin	BNT7122	Handle Assembly
BNT2123	Click Spring	BNT5319	Bearing Retainer	BNT7123	Star Drag
BNT2127	Star Drag Spacer	BNT5327	Idle Gear Spring	BNT7124	Washer
BNT2224	Spool Tension Spacer A	BNT5329	Drive Shaft Retainer	BNT7126	Roller Clutch Inner Tube
BNT3627	Ball Bearing	BNT5334	Bushing	BNT7127	Anti-Reverse Ratchet
BNT3927	Ball Bearing	BNT5346	Spacer	BNT7128	Drive Shaft
BNT4116	Screw	BNT5376	Drag Spring Washer	BNT7129	Screw
BNT4124	Star Drag Spring	BNT5383	Line Guide Pawl	BNT7130	Worm Shaft
BNT4187	Ball Bearing	BNT5385	Clutch Pawl Spring	BNT7131	Level Wind Guard
BNT4194	Ball Bearing	BNT5409	Drive Shaft Bushing	BNT7132	Level Wind Protector
BNT4588	Washer	BNT5640	Screw	BNT7133	Screw
BNT4625	Drag Washer C	BNT5651	Drag Washer A	BNT7134	Clutch Button
BNT4729	O Ring	BNT5658	Screw	BNT7135	Screw
BNT4814	Screw	BNT5715	Washer	BNT7136	Substrate Plate Sticker
BNT4863	Star Drag Nut	BNT5762	Screw	BNT7137	Substrate Plate
BNT4865	Bearing Spacer	BNT5780	Roller Clutch Bearing	BNT7139	Dial Case
BNT4872	Idle Gear A	BNT5860	Star Drag Click Plate	BNT7140	B Side Plate Cam Lever
BNT4874	Pawl Cap	BNT5932	Screw	BNT7141	Washer
BNT4877	Idle Gear C	BNT5969	Bearing Seal	BNT7142	Click Ring
BNT4878	Worm Shaft Pin	BNT5984	Washer	BNT7143	Left Side Plate
BNT4882	Yoke Spring	BNT6159	Handle Nut	BNT7144	Right Side Plate
BNT4883	Yoke	BNT6555	Washer	BNT7157	Frame Assembly
BNT4884	Clutch Cam Retainer	BNT6562	Handle Knob Seal	BNT7158	Spool Assembly
BNT4885	Clutch Cam	BNT6570	Handle Knob	BNT7159	Brake Dial Assembly
BNT4886	Clutch Pawl Assembly	BNT6655	Washer	BNT7165	Left Side Plate Assembly
BNT4887	Clutch Plate	BNT6672	Drive Gear	BNT7167	B Side Plate Substrate
BNT4888	Clutch Guard	BNT6673	Pinion Gear		
BNT4890	Clutch Bar Guide	BNT6693	Cast Control Cap		
BNT4893	Washer	BNT6701	Spacer		
BNT5072	Line Guide	BNT6704	Washer	BNT4692	B-100 Oil (Accessory)